

Clarke®

air



12 INCH FLOOR FAN

MODEL NO: CFF1250

PART NO: 3231545

OPERATION & MAINTENANCE INSTRUCTIONS

UK
CA | CE



ORIGINAL INSTRUCTIONS

GC04/24

INTRODUCTION

Thank you for purchasing this CLARKE 12 inch Floor Fan.

Before attempting to use this product, please read this manual thoroughly and follow the instructions carefully. In doing so you will ensure the safety of yourself and that of others around you, and you can look forward to your purchase giving you long and satisfactory service.

PRODUCT SPECIFICATIONS

Voltage		230 Vac ~ 50Hz
Fan Speeds		3
	Setting 1 (Low)	1155 rpm
	Setting 2 (Medium)	1250 rpm
	Setting 3 (High)	1340 rpm
Maximum Airflow		47.7 (m ³ /min)
Fan Power Input		45.8 W
Service Value		1.00 (m ³ /min) / (W)
Measurement standard for service value		14.7 kWh/a
Ingress protection rating		IPX0 (no water protection)
Sound Power level		56 dB(A)
Maximum Air Velocity		3.2 m/s
Dimensions (W x D x H)		390 x 170 x 400 mm
Weight		2.7 kg

GUARANTEE

This product is guaranteed against faulty manufacture for a period of 12 months from the date of purchase. Please keep your receipt which will be required as proof of purchase.

This guarantee is invalid if the product is found to have been abused or tampered with in any way, or not used for the purpose for which it was intended.

Faulty goods should be returned to their place of purchase, no product can be returned to us without prior permission.

This guarantee does not effect your statutory rights.

ELECTRICAL CONNECTIONS



WARNING: READ THESE ELECTRICAL SAFETY INSTRUCTIONS THOROUGHLY BEFORE CONNECTING THE PRODUCT TO THE POWER SUPPLY.

Before switching the product on, make sure that the voltage of your electricity supply is the same as that indicated on the rating plate. This product is designed to operate on 230VAC 50Hz. Connecting it to any other power source may cause damage.

This product may be fitted with a non-rewireable plug. If it is necessary to change the fuse in the plug, the fuse cover must be refitted. If the fuse cover becomes lost or damaged, the plug must not be used until a suitable replacement is obtained.

If the plug has to be changed because it is not suitable for your socket, or due to damage, it should be cut off and a replacement fitted, following the wiring instructions shown below. The old plug must be disposed of safely as insertion into a mains socket could cause an electrical hazard.

If the colours of the wires in the power cable of this product do not correspond with the markings on the terminals of your plug, proceed as follows.

- The **Blue** wire must be connected to the terminal marked **N** or coloured **Black**.
- The **Brown** wire must be connected to the terminal marked **L** or coloured **Red**.
- The **Yellow and Green** wire must be connected to the terminal marked **E** or  or coloured **Green**.

Plug must be BS1363/A approved.

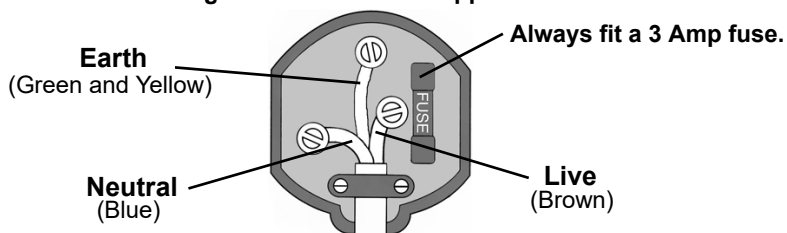

Ensure that the outer sheath of the cable is firmly held by the clamp

If in any doubt, consult a qualified electrician. **DO NOT** attempt any repairs yourself.

SAFETY PRECAUTIONS

- **DO NOT** use in dusty environments.
- **DO NOT** use in environments with high fumes from chemicals etc.
- **DO NOT** use as an extractor fan.
- **DO NOT** use in areas of high humidity/water vapour, i.e. bathrooms etc.
- **DO NOT** connect fan to ducting system.
- **DO NOT** cover the fan with clothing or any material that will restrict free airflow through the fan
- **NEVER** touch the blades with your hand or any object.
- This product is for indoor use only.

OPERATION

TILTING THE FAN

You can adjust the angle of the fan by holding the base and grill and tilting the fan to the required angle.

- Tighten the nuts on the side of the fan slightly if the fan will not stay in position

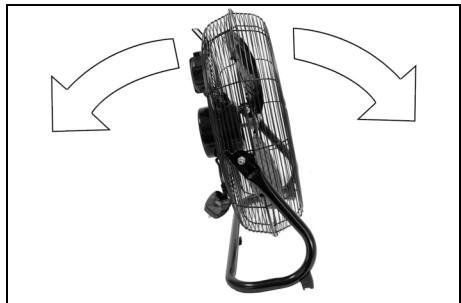

ADJUSTING THE SPEED

Press the relevant button to select the fan speed required

- Button 0 - Off
- Button 1 - 1155 rpm
- Button 2 - 1250 rpm
- Button 3 - 1340 rpm

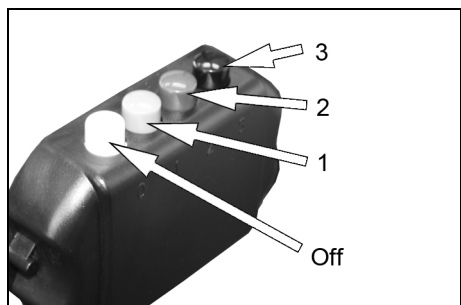

MAINTENANCE



WARNING: NEVER OPERATE THE FAN WITH THE GUARDS REMOVED.

CLEANING

1. Unplug the power cable from the power supply.
2. Lift the guard clips and remove the single bolt and nut found at the bottom of the guard.
3. Remove the guard carefully.
4. Wipe fan blades with a dry cloth.
 - NEVER use polish or any corrosive liquid that will damage the finish.
 - Take care not to bend the blades.
5. Replace the guard so that the bolt holes in the front and rear guard line up and lock the guard securely before use.
 - Make sure that the guard clips are returned to the locked position.

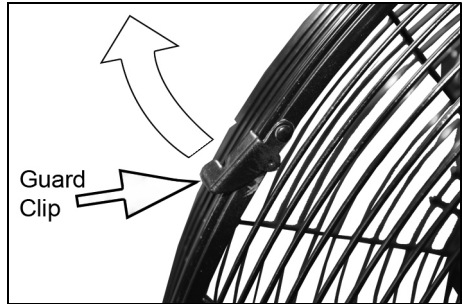

GENERAL CARE

- The motor bearings are sealed for life and do not require any additional lubrication.
 - Have any repairs carried out by a suitably qualified person.
-

ENVIRONMENTAL RECYCLING POLICY



Through purchase of this product, the customer is taking on the obligation to deal with the WEEE in accordance with the WEEE regulations in relation to the treatment, recycling & recovery and environmentally sound disposal of the WEEE.

In effect, this means that this product must not be disposed of with general household waste. It must be disposed of according to the laws governing Waste Electrical and Electronic Equipment (WEEE) at a recognised disposal facility.

COMPONENT PARTS

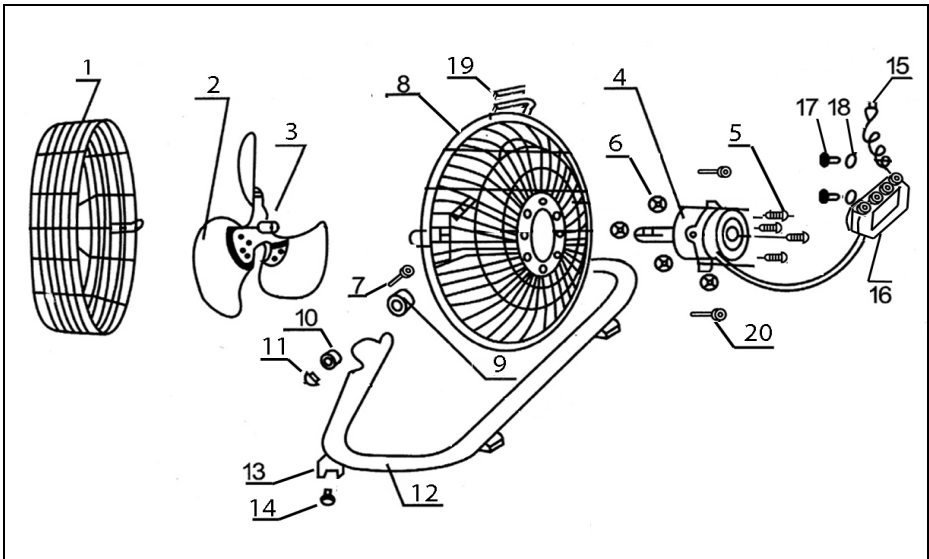

No	DESCRIPTION
1	Front guard with clips
2	Fan blade assembly
3	Set screw
4.	Motor
5	X-head screw
6	Dome nut
7	Coach bolt
8	Rear guard
9	Plastic spacer
10	Locknut

No	DESCRIPTION
11	Rubber cap
12	Base frame
13	Plastic foot
14	Screw
15	Power cable
16	Control switch box
17	Screw
18	Washer
19	Handle grip
20	Self tapping screw

DECLARATION OF CONFORMITY



INTERNATIONAL
Flizwilliam Hall, Flizwilliam Place, Dublin 2

DECLARATION OF CONFORMITY

This is an important document and should be retained.

We hereby declare that this product(s) complies with the following legislation:

- 2009/125/EC *Ecodesign Directive*
- 2014/30/EU *Electromagnetic Compatibility Directive*
- 2014/35/EU *Low Voltage Directive*
- 2011/65/EU *Restriction of Hazardous Substances (RoHS) Directive*

The following standards have been applied to the product(s):

- EN 60335-1:2012+A1:2014+A13:2017+A14:2019+A14.2:2019+A14.2:2019, EN 60335-2-80:2003+A1:2004+A2:2009, EN 61000-3-3:2013+A1:2019, EN 55014-1:2017+A1:2020, EN 60704-1:2010+A1:2012, IEC 62321-3-1:2013, IEC 60879-1988/COR1:1992, EN IEC 61000-3-2:2019, IEC 62321-1-1:2015, IEC 62321-4:2017, EN 62233:2008, IEC 62321-5:2013, IEC 62321-6:2015, IEC 62321-8:2017, EN 60704-2-7:1998, IEC 62321-7-2:2017, EN 55014-2:2015, EN 50564:2011

The technical documentation required to demonstrate that the product(s) meet(s) the requirement(s) of the aforementioned legislation has been compiled and is available for inspection by the relevant enforcement authorities.

The CE mark was first applied in: 2024

Product Description: Floor Fan
Model Number(s): CFF1250
Serial/Batch Number: Refer to product/packaging label
Date of Issue: 18/01/2024

Signed: 
 J.A. Clarke
 Director



INTERNATIONAL
Hemmill Street, Epping, Essex, CM16 4LG

DECLARATION OF CONFORMITY

This is an important document and should be retained.

We hereby declare that this product(s) complies with the following legislation:

- The Ecodesign for Energy-Related Products Regulations 2010*
- The Electromagnetic Compatibility Regulations 2016*
- The Electrical Equipment (Safety) Regulations 2016*
- The Restriction of the Use of Certain Hazardous Substances in Electrical and Electronic Equipment Regulations 2012*

The following standards have been applied to the product(s):

- EN 60335-1:2012+A11:2014+A13:2017+A14:2019+A14.2:2019, EN 60335-2-80:2003+A1:2004+A2:2009, EN 61000-3-3:2013+A1:2019, EN 55014-1:2017+A1:2020, EN 60704-1:2010+A1:2012, IEC 62321-3-1:2013, IEC 60879-1988/COR1:1992, EN IEC 61000-3-2:2019, IEC 62321-1:2015, IEC 62321-4:2017, EN 62233:2008, IEC 62321-5:2013, IEC 62321-6:2015, IEC 62321-8:2017, EN 60704-2-7:1998, IEC 62321-7-2:2017, EN 55014-2:2015, EN 50564:2011

The technical documentation required to demonstrate that the product(s) meet(s) the requirement(s) of the aforementioned legislation has been compiled and is available for inspection by the relevant enforcement authorities.

The UKCA mark was first applied in: 2024

Product Description: Floor Fan
Model Number(s): CFF1250
Serial/Batch Number: Refer to product/packaging label
Date of Issue: 18/01/2024

Signed: 
 J.A. Clarke
 Director

A SELECTION FROM THE VAST RANGE OF

Clarke®

QUALITY PRODUCTS



AIR COMPRESSORS

From DIY to industrial, Plus air tools, spray guns and accessories.

GENERATORS

Prime duty or emergency standby for business, home and leisure.

POWER WASHERS

Hot and cold, electric and engine driven - we have what you need

WELDERS

Mig, Arc, Tig and Spot. From DIY to auto/industrial.

METALWORKING

Drills, grinders and saws for DIY and professional use.

WOODWORKING

Saws, sanders, lathes, mortisers and dust extraction.

HYDRAULICS

Cranes, body repair kits, transmission jacks for all types of workshop use.

WATER PUMPS

Submersible, electric and engine driven for DIY, agriculture and industry.

POWER TOOLS

Angle grinders, cordless drill sets, saws and sanders.

STARTERS/CHARGERS

All sizes for car and commercial use.

PARTS & SERVICE:

0208 988 7400

Parts Enquiries

Parts@clarkeinternational.com

Servicing & Technical Enquiries

Service@clarkeinternational.com

SALES: UK 01992 565333 or Export 00 44 (0)1992 565335

Clarke INTERNATIONAL Hemnall Street, Epping, Essex CM16 4LG
www.clarkeinternational.com